

Eccentrico in zama $\varnothing 25$

Articolo	Finitura	Misura mm
B0012	10	A \varnothing 25-B9,4



pz. 200



Giunzione in zama

Articolo	Finitura	Misura mm
B0017	50-60-80	A12,5-Bø20



pz. 250

le finiture 60 e 80 sono in plastica

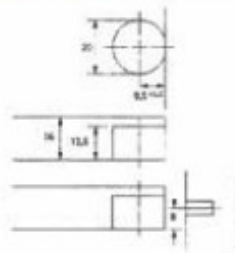
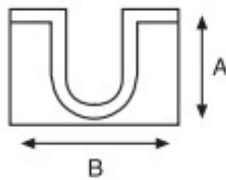

Giunzione in zama

Articolo	Finitura	Misura mm
B0018	50	A12-B15



pz. 200

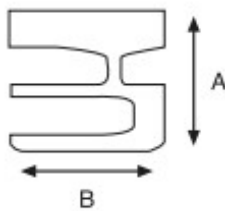

Giunzione in plastica con bordo

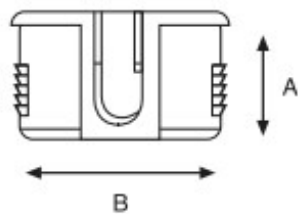

Articolo	Finitura	Misura mm
B0024	60	A15,5-B \varnothing 26

 pz. 100

Giunzione in metallo senza bordo

Articolo	Finitura	Misura mm
B0027	10	A14-B \varnothing 18



pz. 100

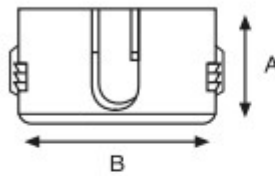

Giunzione in plastica con premontaggio

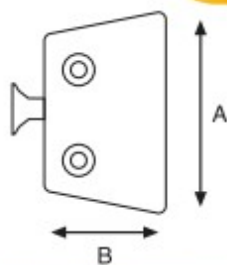

Articolo	Finitura	Misura mm
B0042	60-80	A38-B20

 pz. 50

Giunzione in metallo con premontaggio

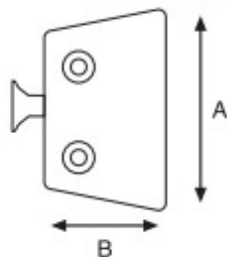

Articolo	Finitura	Misura mm
B0043	30-50	A38-B20

 pz. 50

Giunzione in acciaio per piani

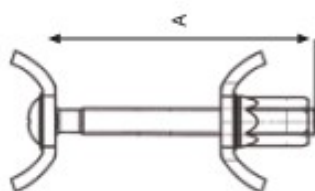

Articolo	Finitura	Misura mm
B0056	10	A65
B0057	10	A150



pz. 20

Vite di congiunzione

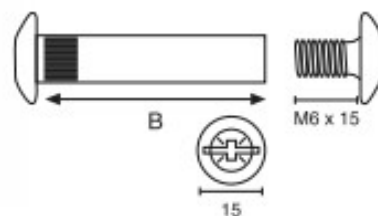

Articolo	Finitura	Misura mm
B0058	30-50	6MA-B31
B0137	50	6MA-B38

Articolo	Finitura	Misura mm
B0058N	50	6MA-B31

 pz. 200

Vite di congiunzione

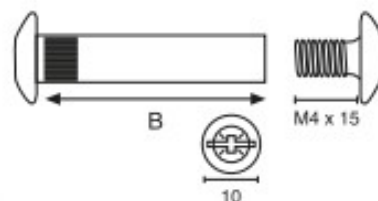

Articolo	Finitura	Misura mm
B0139	50	4MA-B30

Articolo	Finitura	Misura mm
B0139N	50	4MA-B30

 pz. 200

Ferriletto a baionetta

Articolo	Finitura	Misura mm
B0065	10	A125-B127



grn. 10

grn. = 4 maschi + 4 femmine

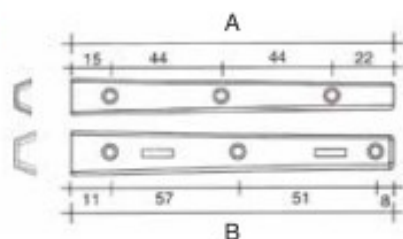

Ferriletto trafileto

Articolo	Finitura	Misura mm
B0240	10	A14-B101
B0241	10	A14-B120



pz. 48

pz. = 1 maschi + 1 femmine

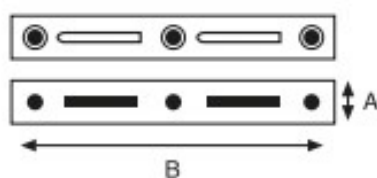

Ferriletto ad angolo

Articolo	Finitura	Misura mm
B0242	10	A20-B95



st. 1

st. = pz. 4

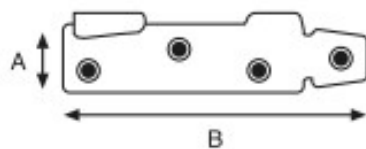

Giunzione per piani pesanti

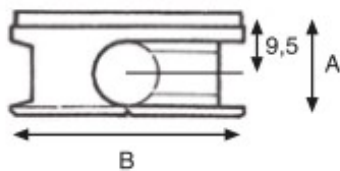

Articolo	Finitura	Misura mm
B0188	10	A16-Bø35

 pz. 50

Giunzione senza bordo per piani pesanti

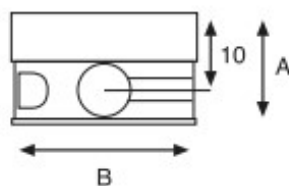

Articolo	Finitura	Misura mm
B0029	10	A15-Bø22

 pz. 100

tappo di copertura vedi B0025 e B0389

Giunzione in metallo con vite

Articolo	Finitura	Misura mm
B0214	10-20-30	A13-B38

 pz. 100

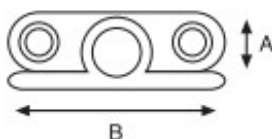

Giunzione in metallo con montaggio vite frontale

Articolo	Finitura	Misura mm
B0405	10-20-30	A20 - B35

 pz. 200

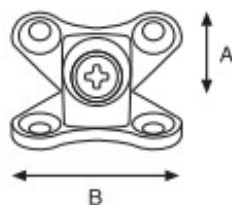

Giunzione in plastica con vite

Articolo	Finitura	Misura mm
B0406	60-80-90	A20 - B35

 pz. 200

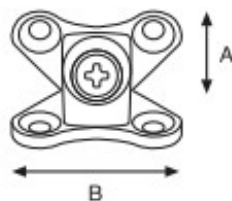

Giunzione in plastica con copertura in metallo

Articolo	Finitura	Misura mm
B0045	60-80	A27-B33

 pz. 100

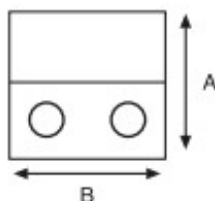

Giunzione angolare in plastica con copertura

Articolo	Finitura	Misura mm
B0221	60-80	A20-B43

 pz. 100

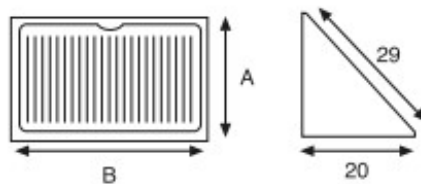

Giunzione in metallo

Articolo	Finitura	Misura mm
B0223	50	A15-B ϕ 18



pz. 100

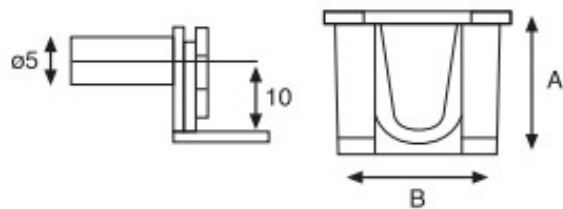

Giunzione pesante a "T"

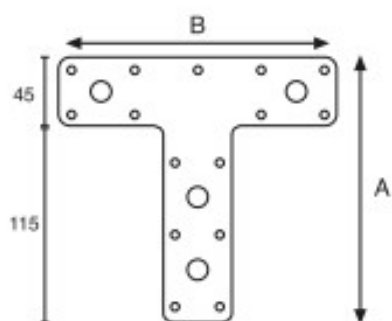

Articolo	Finitura	Misura mm
B0256	10	A160-B160



pz. 10

Giunzione a cremagliera c/perno

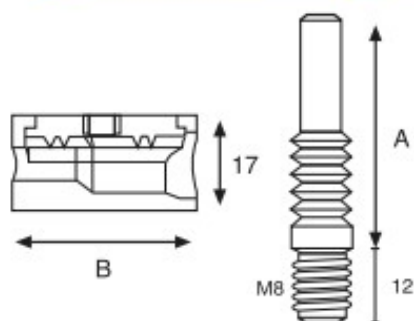

Articolo	Finitura	Misura mm
B0303	10	A52-Bø35

 pz. 100

Guida Stick diritta in plastica per ripiani

Articolo	Finitura	Misura mm
B0330	80	300
B0331	80	500



pz. 20



misura 300 = L15,8-S14
misura 500 = L15,8-S14
L=Larghezza-S=Spessore

Giunzione in faggio per pannelli

Articolo	Finitura	Misura
B0366	88	20



pz. 1000

